

- EN ▶ ELECTRIC CLEANER
- ES ▶ LIMPIAFONDOS ELÉCTRICO
- FS ▶ NETTOYEUR DE FOND ÉLECTRIQUE
- DE ▶ ELEKTROBECKENREINIGER
- IT ▶ PULITORE ELETTRICO
- NL ▶ ELEKTRISCHE ZWEMBADREINIGER
- PT ▶ LIMPAFUNDOS ELÉCTRICO



Instruction Manual - Manual de Instrucciones Manuel d'instructions - Bedienungsanleitung Manuale delle istruzioni - Handleiding met instructies Manual de instruções

We reserve to change all of part of the articles or contents of this document, without prior notice.

Nos reservamos el derecho de cambiar total o parcialmente las características de nuestros artículos o contenido de este documento sin previo aviso.

Nous nous réservons le droit de modifier totalement ou en partie les caractéristiques de nos articles ou le contenu de ce document sans préavis.

Wir behalten uns das recht vor die eigenschaften unserer produkte oder den inhalt diese prospektes teilweise oder wollstanding, ohne vorherige benachichtigung zu andern.

Ci riservamo il diritto di cambiare totalmente o parzialmente le caratteristiche tecniche dei nostri prodotti ed il contenuto di questo documento senza nessun preavviso.

Wij behouden ons het recht voor geheel of gedeeltelijk de kenmerken van onze artikelen of de inhoud van deze handleiding zonder voorafgaand bericht te wijzigen.

Reservamo-nos no direito de alterar, total ou parcialmente as características os nossos artigos ou o conteúdo deste documento sem aviso prévio.

EN
Electrical Vacumm Cleaner

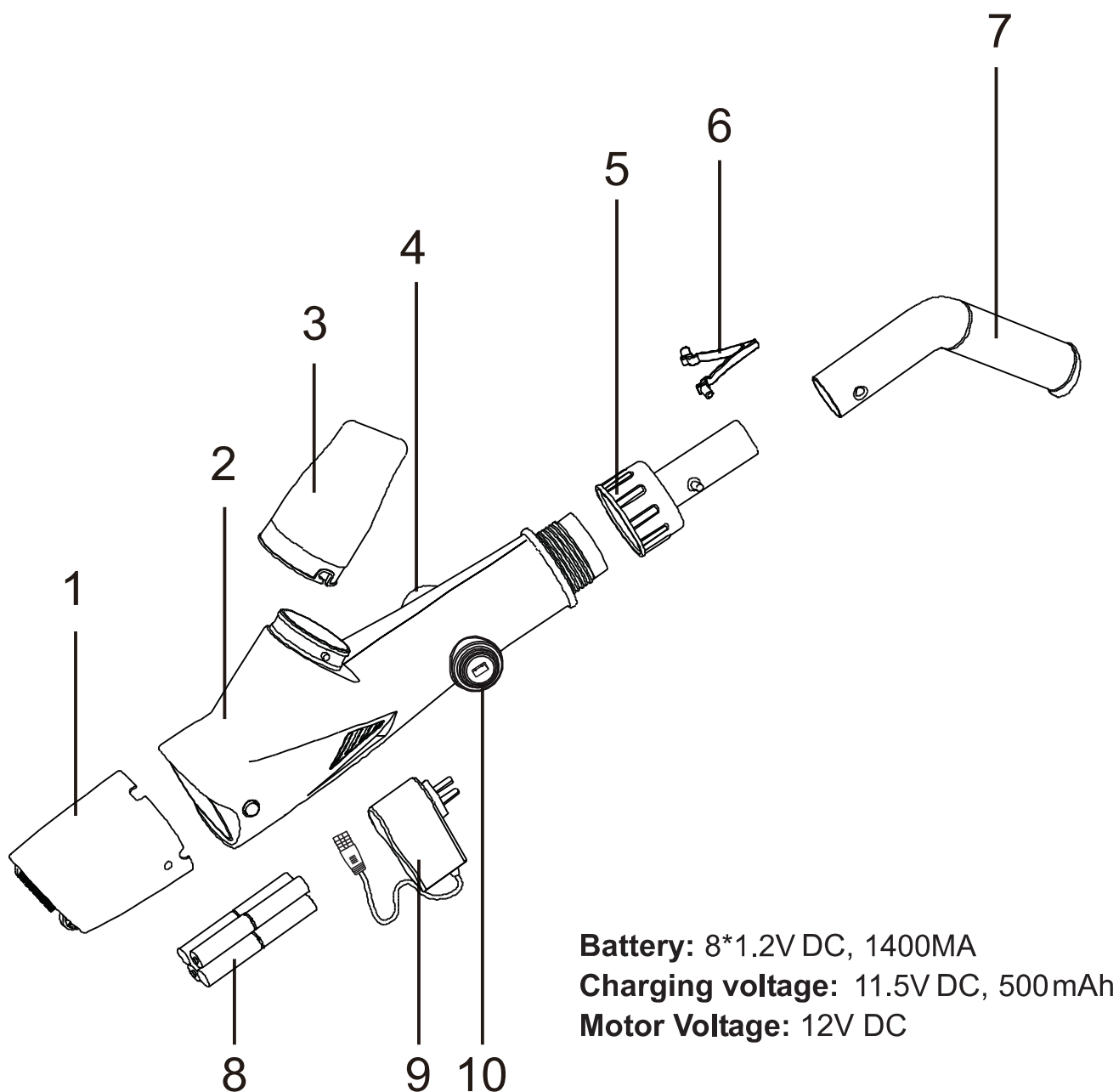

1. Transparent suction head part	6. Clip
2. Cleaner body	7. Handle
3. Filter bag	8. Battery
4. Button	9. Charger
5. Connector	10. Charging hole

SAFETY WARNINGS & INSTRUCTIONS

Read and follow all instructions in this manual and on the equipment. Failure to do so could result in severe or fatal injury.

GETTING STARTED

1. Suction head assembly

Insert suction head into the body until two buttons of body sides popping from holes of suction head. Please keep the notch facing up.

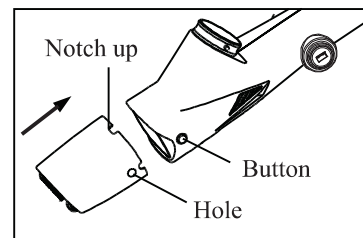

2. Battery assembly and replacement

- (1) Push the button “a” forward along the arrow direction, until it not stuck the slot of the connector.(as picture A shown)
- (2) Holding the body while reversing the connector , and removing the battery mounting from the body.(as “b” in picture B shown)
- (3) Remove the used battery, and replace new NI-MH battery(or AA Alkaline battery for P1112) according to the sign of positive & negative pole of the battery mounting.(as shown in picture C)
- (4) Install the battery mounting into the body(as picture D shown, pay attention the positive & negative pole of the mounting(as picture d shown,)and the 2 springs (as picture “d1” shown)alignment.
- (5) Twist the connector into the body in clockwise, until the button “a” can buckle in the slot of connector. As picture E shown.
- (6) Now you can use the cleaner according to the instruction normally.

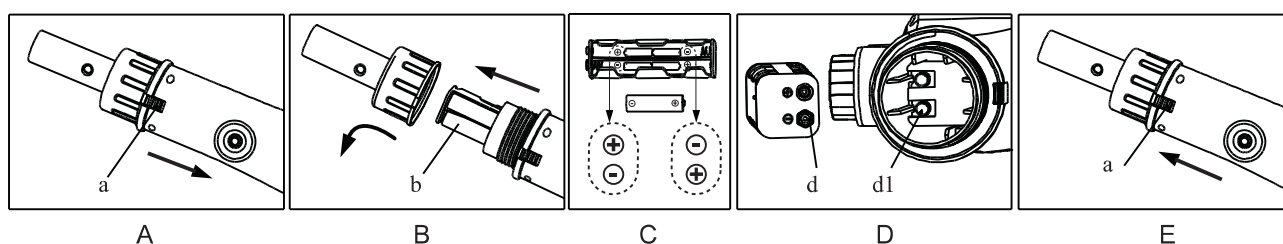

BATTERY DISPOSAL

Your Rechargeable Pool Vacuum Battery is a NI-MH battery which must be disposed of properly is required; please contact your local authority for information.

WARNING!

Never attempt to disassemble a NI-MH battery.

Remove all personal items such as rings, bracelets, necklaces and watches when unwiring a NI-MH battery from the vacuum unit.

A battery can produce a short circuit current high enough to weld a ring (or like item) to metal causing a severe burn.

Wear complete eye protection, gloves and protective clothing when removing the battery pack.

Take care not to touch wires together or allow them to contact any metal items, which would cause sparking and/or short circuit the battery.

Never smoke or allow a spark or flame in the vicinity of the cleaner. Batteries can generate gases which could possibly ignite.

If a battery leak develops, avoid contact with the leaking acid and place the damaged battery in a plastic bag.

Do Not expose to fire or intense heat as this may result in an explosion.

CAUTION!

If a battery leak develops, avoid contact with the leaking acid and place the damaged battery in a plastic bag.

If acid comes in contact with skin and clothing, wash immediately with plenty of soap and water.

If acid comes in contact with eyes, immediately flood eye with running cool water for at least 15 minutes. Get medical attention immediately.

3. Charger set up

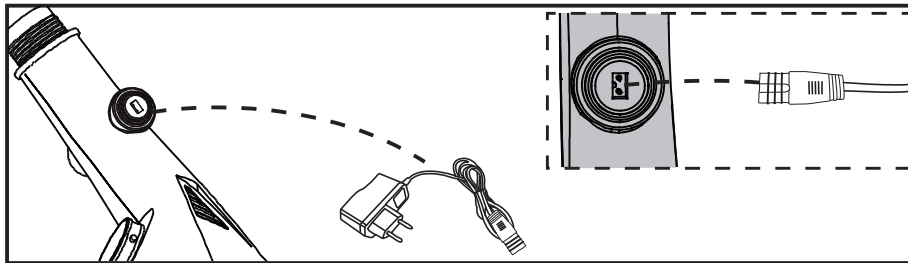

(1) Plug one end of the charger into the socket, and the charger is green.

(2) Then, plug one end of charger to P1113, the charger is red, the charger is working now.

Note: When the battery power completely exhausted, it is normal that the charging indicator will be flashing for 20-50 seconds. Then the indicator will turn into red and the battery will be charging correctly.

(3) After charging 2.5-3 hours, the charger becomes green, and P1113 is fully charged.

(4) Now, it is time to work.

WARNING!

Never use the charger if any damage is found.

Use the original the charger provided only.

Make sure cleaner and the charger are clean and dry before set up.

NOTE: Charge the cleaner 3 hours prior to the first use.

Normally cleaner can be operated 45 to 60 minutes after fully charged.

4. Handle assembly

(1). Handle assembly (optional)

(a). Install V-shape clip into connector as Picture A.

(b). Insert the handle as shown behind big department, according to needs, looking for what kind of convenient way to clean the wall,ground,step and seat of the POOL/SPA.

(c). Insert the handle into the cleaner as B shown until the side pin on the handle is secured in the Handle locking hole on the cleaner.

(d). To release the handle, press into the side pin and pull out the handle.

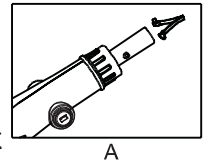

A

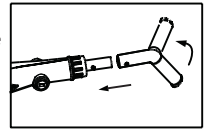

B

(2).Telescopic pole (not included) assembly

(a).Install V-shape clip into connector as Picture A.

(b).Insert the end (with one side pin) of the Pole Connector into the cleaner as shown until its single side pin is secured in the Hand Locking Hole of the cleaner. Slide and align the side holes of the telescopic with the side pins of the Pole Connector.(as Picture B)

(c).To release the telescopic pole, press down two side simultaneously and pull out the pole.

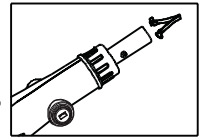

A

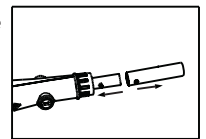

B

(3). Three Aluminum pole assembly (not included)

Insert the threaded pole into battery turn-knob and turn clockwise until the pole tightened. Then match the other two poles by male-female thread.

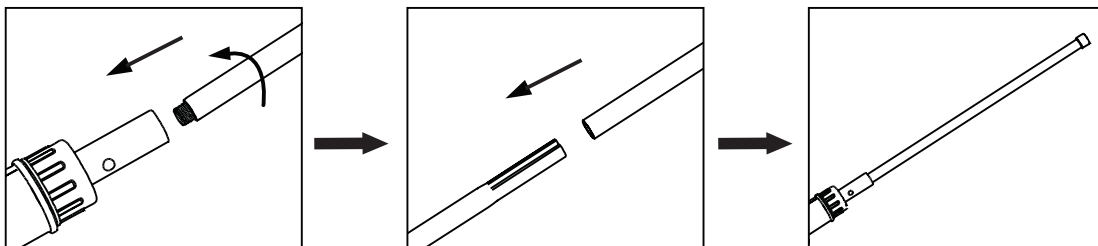

5. Cleaning the cleaner after using the electric cleaner:

(1) Rubbish in head: Press two buttons on body side and remove the suction head from the body. Clean the suction head and insert it into the body again until buttons popping from the holes.

WARNING!

Make sure cleaner is power off when servicing the cleaner.

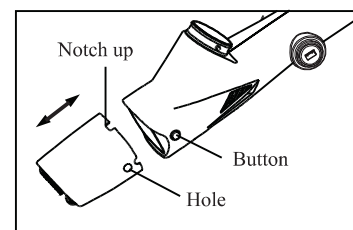

(2) Rubbish in filter bag: one hand holds the body and turn clockwise by another hand to remove the filter bag. Clean it and assemble the filter bag again by turning anticlockwise.

WARNING!

Make sure cleaner is power off when servicing the cleaner.

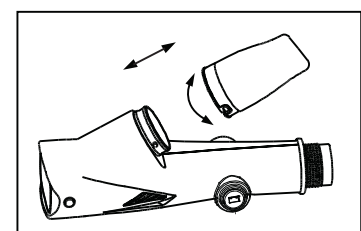

How to clean the dirt on the impeller?

- (1). Turn off cleaner and remove suction part from cleaner body, as Picture A.
- (2). Hold the body, pinch the hand-protection part(Picture B, as “a” shows), turn it clockwise until the end, then drag it out;
- (3). Clean the dirt on the impeller.
- (4). Do the opposite way to assemble the impeller.

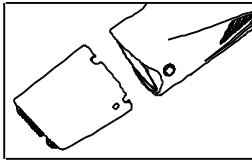

A

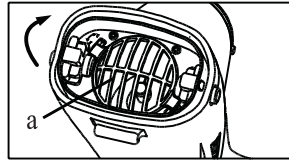

B

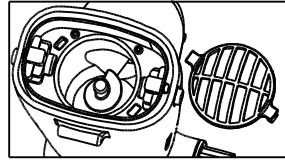

C

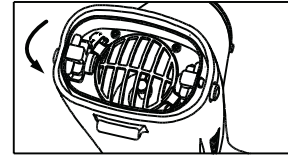

D

WARNING!

This cleaner is not intended for use by persons lack of experience and knowledge, unless they have been given supervision or instruction concerning use of the appliance by a person responsible for their safety.

It is not a TOY. Children should be supervised to ensure that they do not play with this cleaner and its accessories. Never allow children to operate this product. Keep this cleaner and its accessories away from children.

Be sure the cleaner is fully immersed in the water before operation. DO NOT operate it outside of water. It will lead to failure of the shaft seal / motor, and then VOID the warranty.

Maximum operating depth in water: 3 meters (10ft).

Operating water temperature: 4 °C (39.2 °F)-35°C (95°F)

DO NOT use this cleaner if any damage is found.

It is necessary to change parts or assemblies as quickly as possible if they become damaged. Only use parts certified by the distributor or manufacturer.

Detach the cleaner from charger and make sure the cleaner is power off before operating the product.

Do not operate this cleaner when people/pets are in the water.

Risk of Suction Entrapment Hazard. This cleaner generates suction. Avoid hair, body or any loose parts of your clothing to contact with the suction hole of the cleaner in operation.

Never insert body parts, clothing or other objects into the openings and moving parts of the cleaner.

DO NOT use this cleaner to pick up any toxic substance, flammable or combustible liquids such as gasoline, or operate in the presence of explosive or flammable fumes.

Never attempt in any way to disassemble your cleaner on your own.

Under no circumstances should you attempt to disassemble the cleaner and replace the impeller, motor by yourself.

Charger:

For indoor use only. The charger should not be used outdoor and not be exposed to rain, humidity, any liquid or heat.

Keep the charger out of reach of children.

Never use the charger if any damage is found.

DO NOT handle the charger with wet hands.

DO NOT handle the cleaner, the charger while charging with wet hands and without shoes.

Disconnect the charger from power when not in use.

If the supply cord is damaged, it must be replaced by the manufacturer or its service agent or a similarly qualified person in order to avoid a hazard.

Make sure the cleaner and charger are totally dry before charging.

CAUTION!

This cleaner is designed for underwater use only, not for use as an all-purpose vacuum cleaner.

DO NOT attempt to use it to clean anything other than your pool / spa.

Use original accessories delivered with this product.

It is not recommended to use this cleaner with another cleaner simultaneously. Avoid picking up sharp objects with this product. They may damage the cleaner and filter.

Use extra care when cleaning stairs in the pool.

Charge the cleaner indoor in a clean, dry place with good ventilation.

If the cleaner is not to be used for an extended period, detach it from the charger, use dry damp cloth to clean and dry the cleaner and accessories. Store them in a well ventilated area away from the sunlight, children, heat, ignition sources and pool chemicals. Never leave the cleaner plugged for long term storage. Recharge the cleaner every three months.

If you do not use the transparent body part, you should take it off the electric cleaner.

Above warnings and cautions are not intended to incorporate all possible instances for risks and / or severe injury. Pool / spa owners should always exercise intensive caution and common sense when operating the cleaner.

OPERATION

Warning

Do not use the cleaner if any damage is found.

Pollution of the liquid could occur due to leakage of lubricants.

Do not operate this cleaner when people/pets are in the water.

Make sure the cleaner is fully immersed in the water before operating. DO NOT operate it outside of water. It will lead to failure of the shaft seals/motor, and then VOID the warranty.

Maximum water temperature: 4 °C (39.2 °F)-35 °C (95 °F)

DO NOT use the cleaner without intact filter sock and sleeve in place. Using you cleaner without intact filter sock and sleeve in place will VOID your warranty.

Risk of Suction Entrapment Hazard. This cleaner generates suction. Avoid hair, body or any loose parts of your clothing to contact with the suction hole of the cleaner in operation.

Never insert body parts, clothing or other objects into the openings and moving parts.

DO NOT use this cleaner to pick up any toxic substance, flammable or combustible liquids such as gasoline, or operate in the presence of explosive or flammable fumes.

CAUTION

Use original accessories delivered with this product with this product.

DO NOT use this cleaner immediately after pool shocking. It is recommended to leave the pool circulating for at least 24-48 hours.

It is not recommended to use this cleaner with another cleaner simultaneously. DO NOT leave the cleaner in the water when not in use or battery is low as water leakage may occur.

The transparent suction part should be well installed before your powering the electric cleaner. (the transparent suction part has the button protection system in case the impeller will get your hands hurt)

TRUBLE SHOOTING

Problem	Possible Cause	Remedy
Cleaner does not capture the debris	Battery is running out	Charge the battery again. Normally cleaner can operate 45~60 minutes after fully charged.
	Impeller is jammed	Power off the cleaner and visually check the gap in middle of the cleaner to see if the impeller is jammed. you can use your hand to rotate the impeller two circles to make the impeller rotation looser. WARNING! Make sure cleaner is power off when servicing the cleaner.
	Impeller is Broken	Contact your dealer for impeller replacement.
	When the filter bag is full	Detach the filter basket and filter bag, and clean them.
Garbage flowing out from the Transparent Suction Head Part	the soft rubber of the rear impeller is broken	The soft rubber of rear impeller is like a door in case the garbage in the filter bag will flow backwards into impeller and the cover of transparent suction head part.
Garbage flow out from the rear filter bag	Filter sock is damaged	Replace a new filter sock.
Handle / pole connector cannot be secured in assembly	Side pin broken	Using the new V-shape clip
Cleaner cannot be recharged	Battery is dead	Contact dealer for battery replacement. WARNING! When you replace NI-MH battery, please contact the local dealers to purchase the original NI-MH battery in case that the electric cleaner is destroyed.

Problem	Possible Cause	Remedy
	The charger is out of order	Contact dealer for proper transformer. WARNING! Using wrong charger will result in damaging the cleaner / battery and void the warranty.

CAUTION!

How to judge whether the battery is destroyed or the impeller is jammed?

1. The impeller suddenly is choked after it worked in a very short time. Turn off the button, and connected the electric cleaner to the civil electricity by means of the charger. If the Green LED is on, it proves that the battery is destroyed(the solution is referring to the step of how to replace the destroyed battery group); if the Red LED is on, start the power of P1113 to see whether the impeller will be rotating or not. If not, it proves that the impeller is jammed.(the solution is referring to how to resolve the problem that the impeller is jammed.)
2. The Green LED indicator is on after it is charged. Start the power, whereas the impeller does not work; turn off the button
 - a. Connect the charger, and press the button to check whether there is the sound of impeller operation. If it product “Kaka” sound, it proves that the impeller is jammed(the solution is referring to how to resolve the problem that the impeller is jammed.)
 - b. Connect the charger, press the button to check whether the impeller works normally. Turn off the button, and if the Green indicator is on, pull charger off the P1113electric cleaner. Start the power again. If the impeller still does not work, it proves that the battery is destroyed.
 - c. Using the voltmeter to judge whether the battery is destroyed or the impeller is obstacle. Firstly charging the battery for more than 10 minutes. Pull the battery out the P1113 electric cleaner, and measure the voltage of the battery. If it is “0”, the battery is in dysfunction; if it is not “0”, it proved that the impeller is jammed.
3. Directly rotate the impeller until it can be moved smoothly(Referring to how to resolve the problem that the impeller is jammed), and have the battery full of electricity. The battery is destroyed if the impeller does not rotate.